

**NEW YORK STATE POLICE**

---

**MEMORANDUM**

Troop D Station SP Marcy

Date May 5, 2020

**To:** Major, Division Traffic Services

**From:** Trooper Michael T. Siegfried *MSS*

**Subject:** **SPEED ENFORCEMENT – LASER SITE ESTABLISHMENT AND MARKING**

On May 5<sup>th</sup>, 2020 writer, assisted by Joseph A. Pisani, measured and marked the LASER CERTIFICATION VERIFICATION site at SP Lee, in the Town of Lee, Oneida County, utilizing New York State Police certified steel tape #NY08-28.

The distance from the reference point to the near target is 56 feet.

The distance from the reference point to the distant target is 88 feet.

The resulting Delta Distance Velocity Check Speed using these two distances is 64 miles per hour.

Cc: Troop D Traffic

# SP LEE

NOTED 05/05/2020

Re-done due to handicapped  
sign taken down in parking lot.

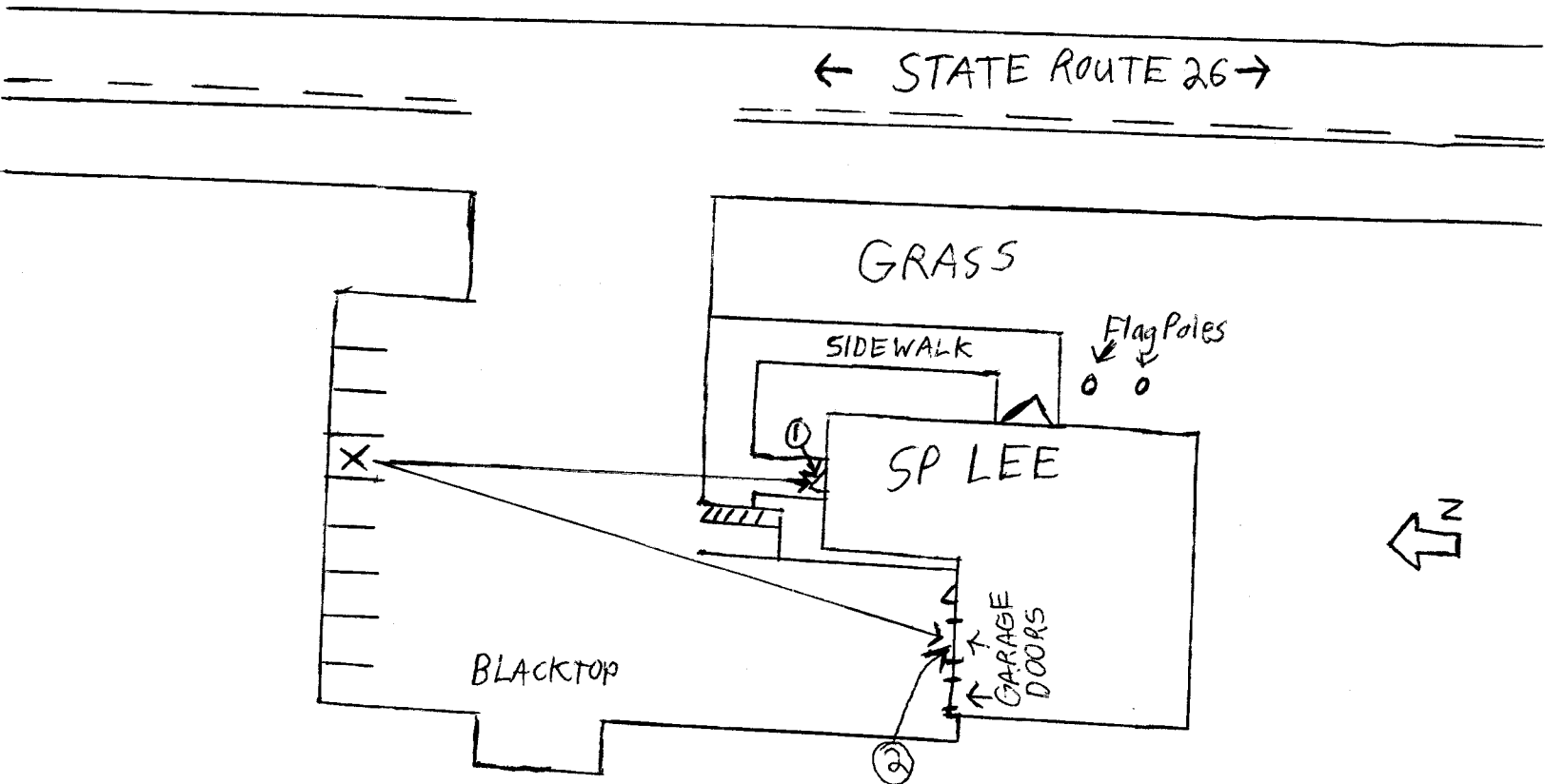

- X - STARTING POINT - PK SURVEYOR'S PIN
- ① - REFERENCE POINT #1 - CENTER OF SIDE DOOR
- ② - REFERENCE POINT #2 - CENTER OF GARAGE DOOR